



# For Lease



109 - 1515 KEEHN ROAD  
KELOWNA BC

**± 1,600 sq. ft. with grade loading directly off Hwy-97**

A **± 1,600 sq. ft.** unit is available with a **12' x 12' grade loading door** and **rear loading** access at Keehn Centre. The leasing opportunity offers **frontage** on Keehn Road and **parking** for customers and employees is abundant. The unit provides flexible configurations with **office, storefront and workspace**. Excellent location, with **direct access to Highway 97** and is one block from **Highway 33**.

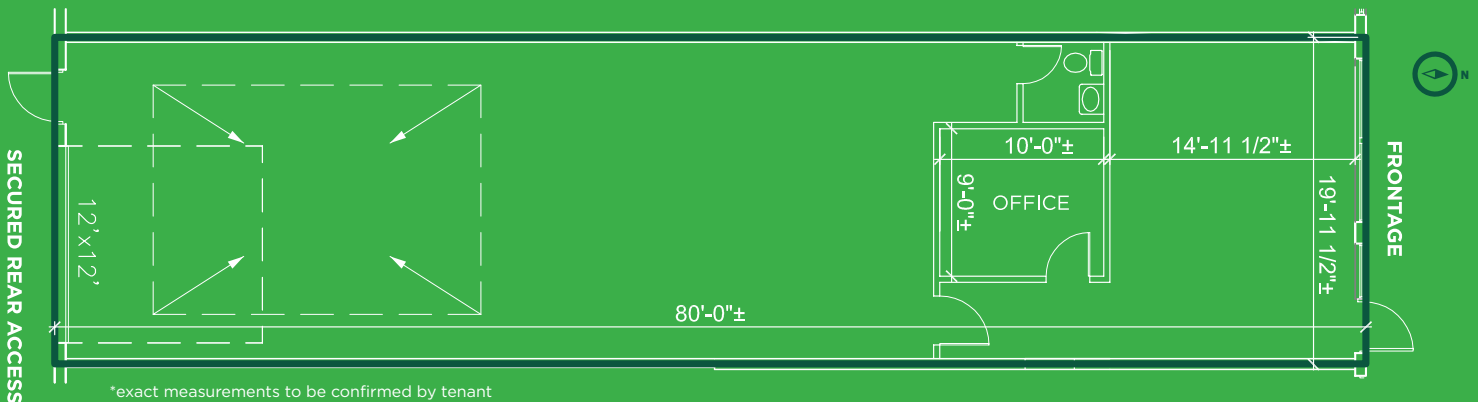

## Highlights



± 1,600 sq. ft. unit



12' x 12' overhead door



Abundant parking for customers & employees



Prominent anchor tenants, such as Lordco Auto Parts, BCAA, Enterprise Rent-a-Car, and more

## Location

Located directly off **Highway 97** with access in both directions and one block from **Highway 33** and the new proposed Canadian Tire Supercentre. Surrounded by amenities, including groceries, shopping, car repair shops, car dealers, hardware stores, and more. Accessible by **public transit**.



Direct Highway 97 access in both directions



Zoning: C2 (Vehicle Oriented Commercial)



Surrounded by amenities

## ABOUT US

Callahan Property Group is a leader in developing, leasing, and managing commercial, build-to-suit, and residential real estate in the Okanagan. We offer a diverse portfolio of **high-quality** properties in optimal locations and take pride in helping tenants **design** and **develop** space that lead to success, and expedite business growth and expansion. For over 60 years, Callahan Property Group has invested in long-lasting connections and building strong partnerships.

## Get in touch

### CALL OR EMAIL TODAY

For leasing & all other inquiries.

**Chad Edwards**  
Senior Leasing Manager

**E** [leasing@callahanpg.ca](mailto:leasing@callahanpg.ca)  
**B** 250.717.3000